

**NAT  
4 / 5**

# **PRACTICAL WOODWORKING COURSE SUPPORT**



## **WOODWORKING HALL UNIT**



**CARCASE  
CONSTRUCTION**

# ASSEMBLED ORTHOGRAPHIC

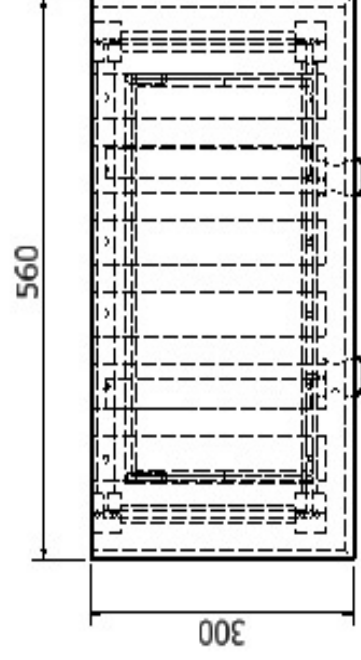

PLAN

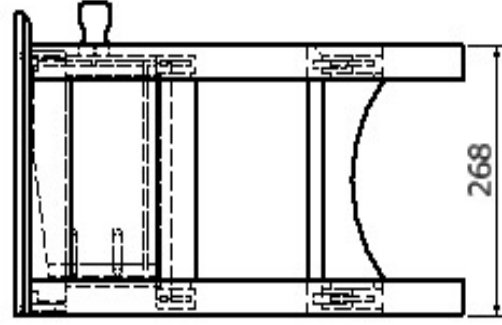

END ELEVATION

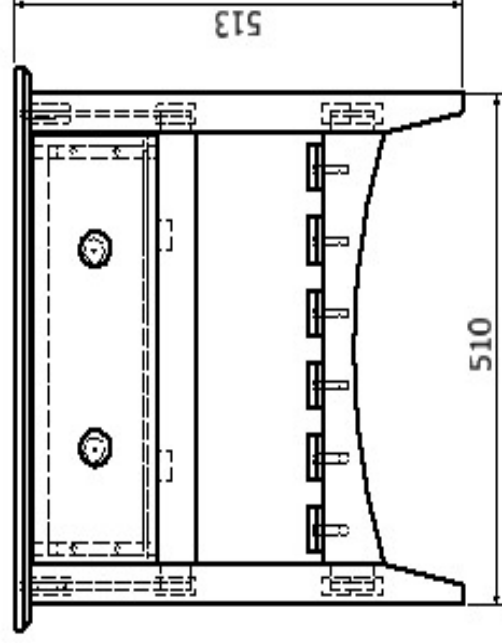

ELEVATION  
SCALE 1 : 4

# CARCASE CONSTRUCTION

## Assembled

### Drawer Orthogarpnic

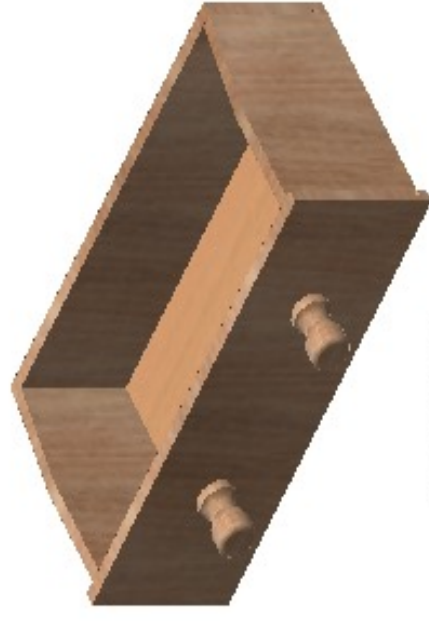

ISOMETRIC  
SCALE 1 : 3

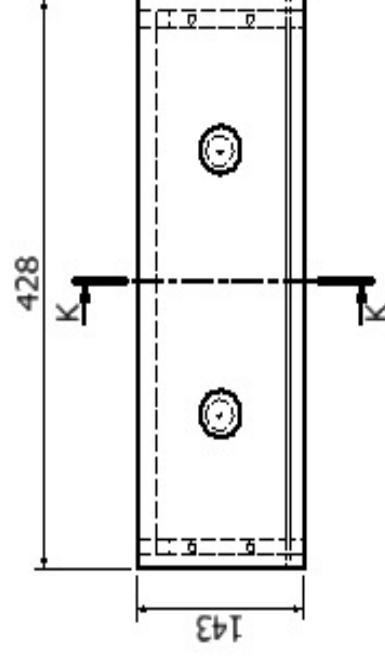
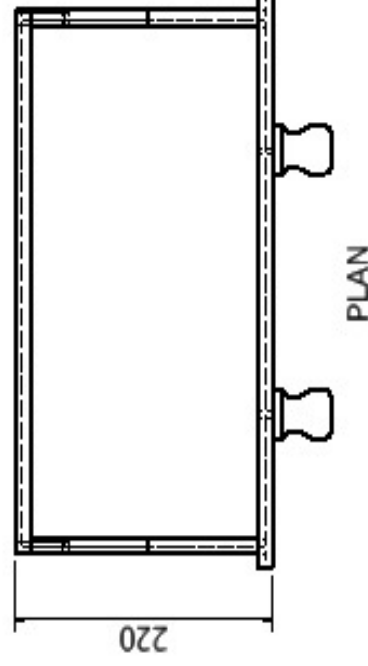

ELEVATION  
SCALE 1 : 3



SECTION K-K

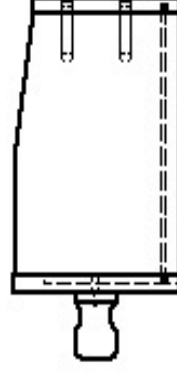

END ELEVATION

# CARCASE CONSTRUCTION

# EXPLODED

# ISOMETRIC

# DRAWER

## SCALE 1 : 3



PARTS LIST						
ITEM	QTY	PART NAME	LENGTH	BREADTH	THICKNESS	
1	1	Drawer Front	428 mm	143 mm	12 mm	
2	1	Drawer Back	408 mm	125 mm	12 mm	
3	1	Drawer Right Side	202 mm	140 mm	12 mm	
5	1	Drawer Base	396 mm	208 mm	5 mm	
9	1	Drawer Left Side	202 mm	140 mm	12 mm	
12	2	Drawer Handle	50 mm	8 mm	8 mm	
13	4	Dowell 6mm	40 mm	6 mm	6 mm	

## CARCASE CONSTRUCTION

### Drawer Front

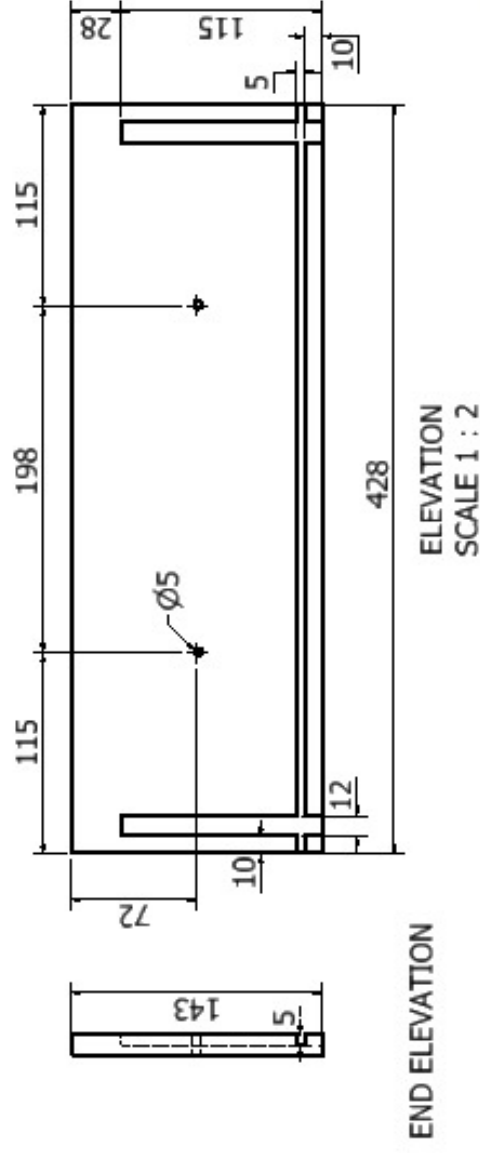

### Drawer Back

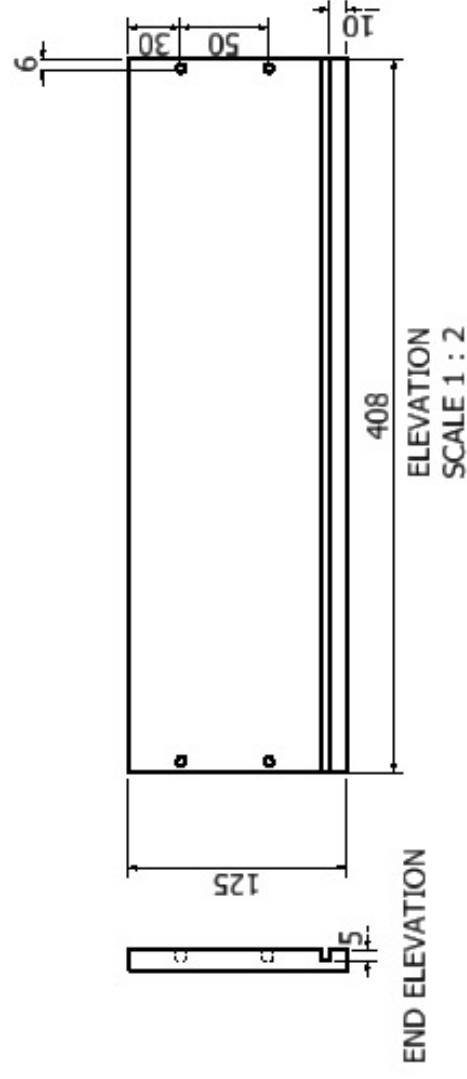

# CARCASE CONSTRUCTION Drawer Side

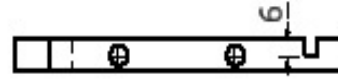
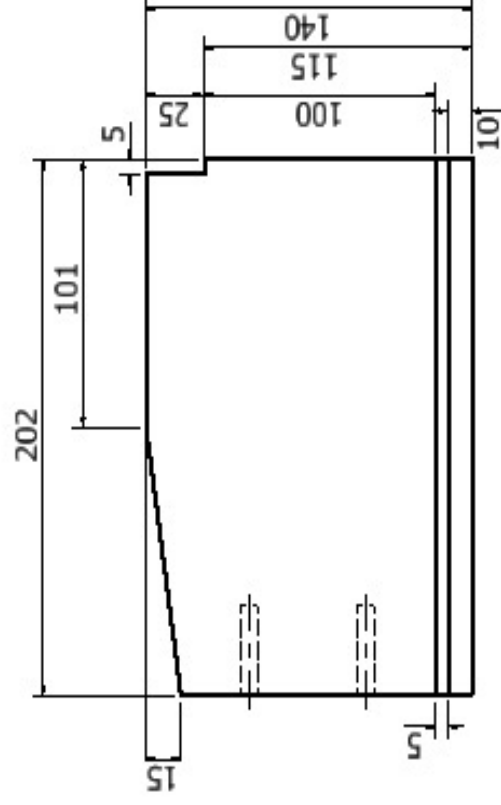
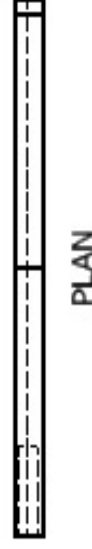

LEFT AND RIGHT DRAWER SIDE  
ARE MIRROR IMAGES OF EACH  
OTHER THEREFORE DIMENSIONS  
ARE THE SAME.

## Table Top

ELEVATION  
SCALE 2 : 3

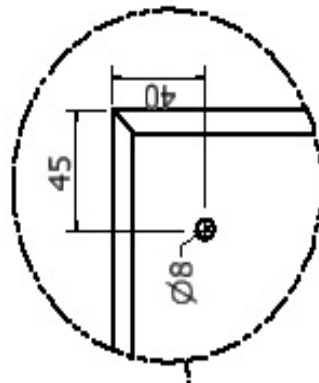
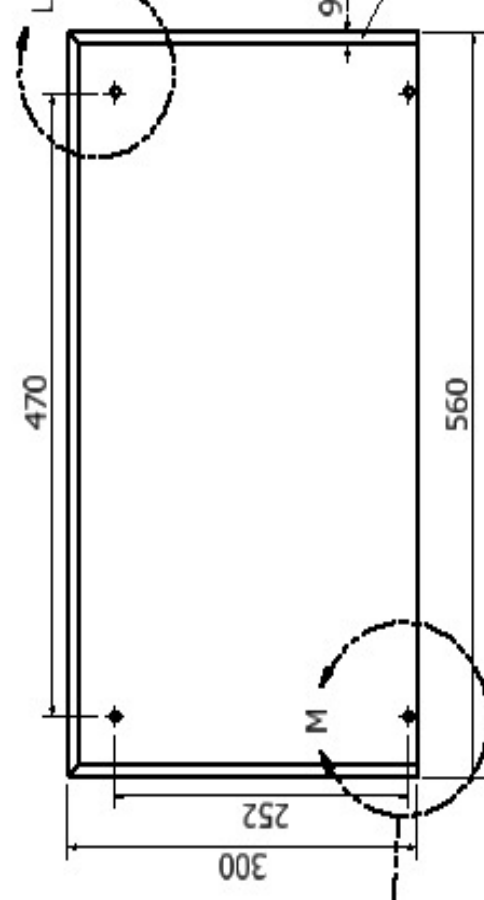

DETAIL M  
SCALE 2 : 3

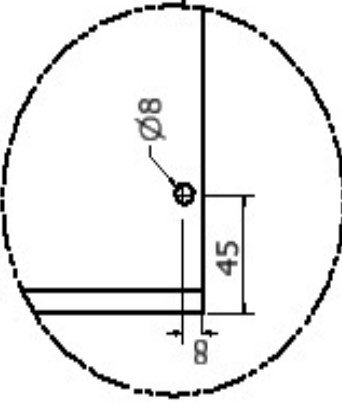

9mm Chamfer around the bottom  
of the Table top.