

# DESIGN BRIEF

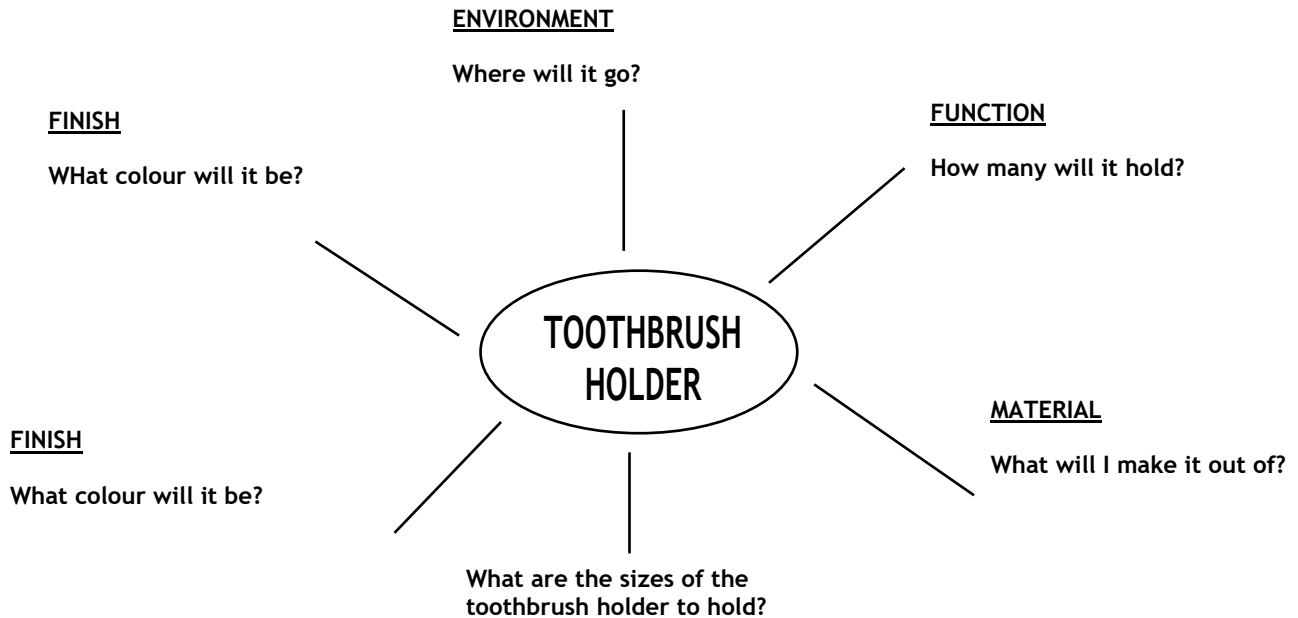

**My problem is to design and make an unusual toothbrush holder.**

# Research



1. Copy the diagram above into your jotter.
2. Answer the questions from the MIND MAP by making a list of items or by making up a questionnaire to find information you may use to make your toothbrush holder.
3. Research the following materials- PINE MAHOGANY MDF
4. If I were to paint the product what colours are available?
5. What other finishes can I use?

# Specifications



## DESIGN FACTORS

Below are the **specifications** for the TOOTHBRUSH HOLDER. The design factors of FUNCTION and FINISH have not been completed. Copy these two into your jotter and complete the statement.



The finished produce must have an interesting shape involving Curves , rounded and regular shapes.



The design will be manufactured out of a material that is available within the department



The desk tidy must be able to stand on a shelf / window sill without falling over.



The design must incorporate a contrast in shapes, colour and size.



The TOOTHBRUSH HOLDER must hold all objects securely, not fall over and have no sharp edges.

# Design Ideas



Shown below are a number of ideas for a toothbrush holders that are already on the market.

## IDEA GENERATION

Draw out some of your ideas for the shape of a possible toothbrush holder. This is called **BRAINSTORMING / THOUGHT SHOWERS**.

You could also use the technique of taking the pencil for a walk to generate a variety of shapes.

Note any aspect of the design you specifically like.

Render one of your ideas to look like pine wood.

Choose one of your ideas and discuss why this one was chosen as a final design.



# Develop Ideas



Once you have chosen your idea that you have been inspired to design and make, you now need to start to plan and develop this idea.

Write out all the things you will need to do to plan and make this product.

Note any sizes which are important as you plan out your idea.

Discuss your idea with your friends / parents / class teacher on how it could be made. Note these discussions in your design jotter.

Remember to model any aspect of your design to help with sizes or to hold any of the products.

# Final Solution



Draw out your final design for your toothbrush holder using the skills taught in graphical communication.

Draw out an ELEVATION and PLAN of your finished design.

Or  
Draw out a picture of your design idea showing the sizes needed to make your product.

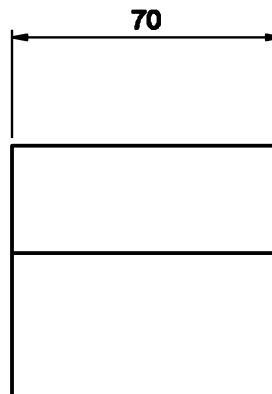
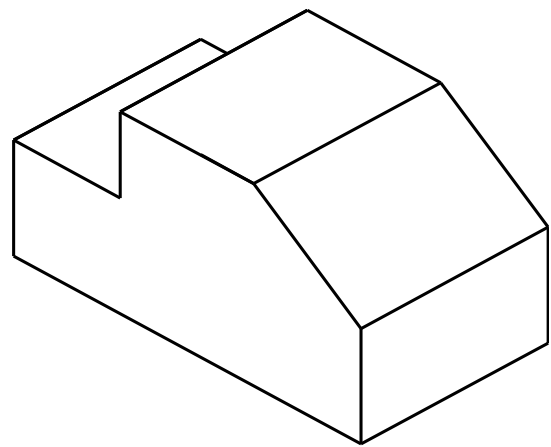
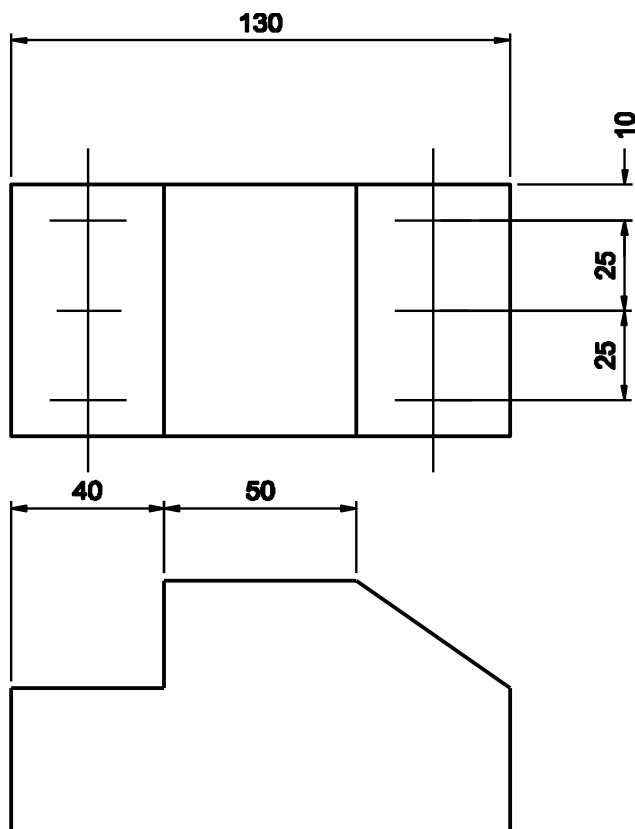

# Manufacture



Before starting your project think about all the steps that you may have to do. Make a list of tools and equipment you may need to use to manufacture your toothbrush holder.

Process	Tools & equipment

# Evaluation



Are the sizes of your model accurate compared to your solution drawing?

1	2	3	4	5
---	---	---	---	---

1 Extremely accurate 2 Very accurate 3 Sizes are out by 5mm  
4 not very accurate 5 completely the wrong size

Grade and evaluate your product by writing a few sentences looking at the following design factors: -

Aesthetics

1	2	3	4	5
---	---	---	---	---

Function

1	2	3	4	5
---	---	---	---	---

Material

1	2	3	4	5
---	---	---	---	---

Finish

1	2	3	4	5
---	---	---	---	---



# Evaluation



In your jotter write out two different design changes you would have made and give reasons for these changes.

Draw out the changes you have discussed

Change 1

Drawing 1

Change 2

Drawing 2